

PART NUMBER

K-10-004



INSTALLATION VIDEO: To see a video of this install, please visit our youtube page - [youtube.com/superspringsinternational](https://www.youtube.com/superspringsinternational).
Install - <https://youtu.be/AKhg6VqjOKc>

BEFORE YOU BEGIN

PRIMARY APPLICATION

- › Ford F53 20k-22k GVWR (2008- present)

TOOLS REQUIRED

- › Floor jack
- › Safety jack stands
- › 9/16" Wrench
- › 7/32" Allen wrench
- › Drill
- › 7/16" Drill Bit
- › 15mm wrench
- › 13mm socket, extension, & socket

PARTS LIST

Item	Part #	Description	QTY
A	511419	SumoSprings Blue -40	2
B	512347	Upper Bracket	2
C	512105	Lower Bracket	2
D	512107	J-bracket clamp	4
E	512244	5/16" flat washers	4
F	512207	3/8-16 x 3/4" serrated flange hex bolt	4
G	512245	3/8-16 x 7/8" flat head allen bolt	2
H	512301	3/8-16 x 1.5" serrated flange hex bolt	4
I	512302	3/8-16 locking flange nut	4

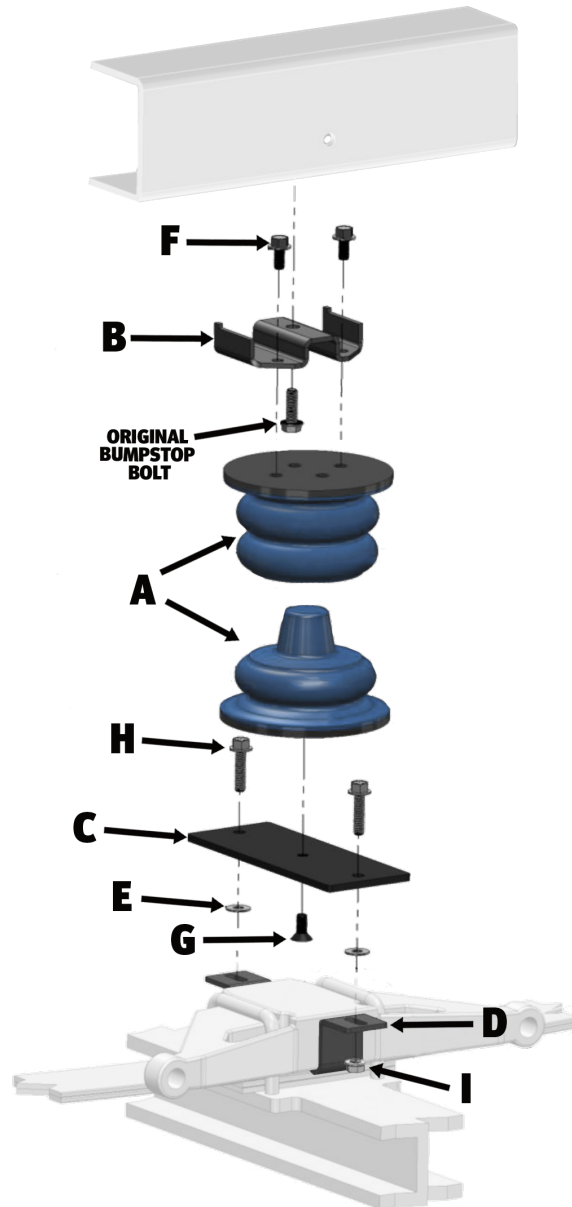

PASSENGER SIDE (DRIVER'S SIDE SIMILAR)

Part Number: K-10-004

► Product Line: SUMOSPRINGS FRONT & REAR

Page 1

SuperSprings International, Inc.

505 Maple Avenue
Carpinteria, CA 93013

Installation Support

+1 (800) 898-0705
support@supersprings.com

superspringsint.com

SAFETY NOTICE: We recommend installation be done by a professional or persons with sound mechanical knowledge.

WARNING: These instructions are a general guide for installation. SuperSprings International, Inc. assumes no liability for the actual installation process. Consumers and installers should apply common automotive safety practices when raising and working on any vehicle. **Do not put yourself in a position where, if the vehicle were to move unexpectedly, you may be injured.** SuperSprings' products are designed to improve vehicle ride quality. Do not load any vehicle beyond the manufacturer's specifications.

Never exceed the manufacturer's Gross Vehicle Rating (GVWR) located on your vehicles identification tag.

BEFORE INSTALLATION: Ensure the vehicle is on a level surface, the parking brake is ON, with the ignition OFF, and place blocks in front of and behind the front tires to prevent the vehicle from moving.

DURING AND/OR AFTER INSTALLATION: Ensure emergency brake cables are not touching the SuperSprings. Secure any cables out of the way with zip ties or by re-routing. **Ensure all A/C lines, brake cables, and frame are clear of contact or interference.**

REV.001 | JULY 2021

PART NUMBER

K-10-004



BEFORE YOU BEGIN

Item	Part #	Description	QTY
A	511405 511403	SumoSprings Blue -40 SumoSprings Yellow-54	2
B	512037	Upper frame bracket	2
C	512108	Lower bracket	2
D	512042	U- bracket strap	2
E	512207	3/8-16 x 3/4" Serrated flange hex bolt	6
F	512301	3/8-16x 1.5" Serrated flange hex bolt	8
G	512292	3/8-16 X 5" Carriage bolts	4
H	512302	3/8-16 Top lock flange nuts	12

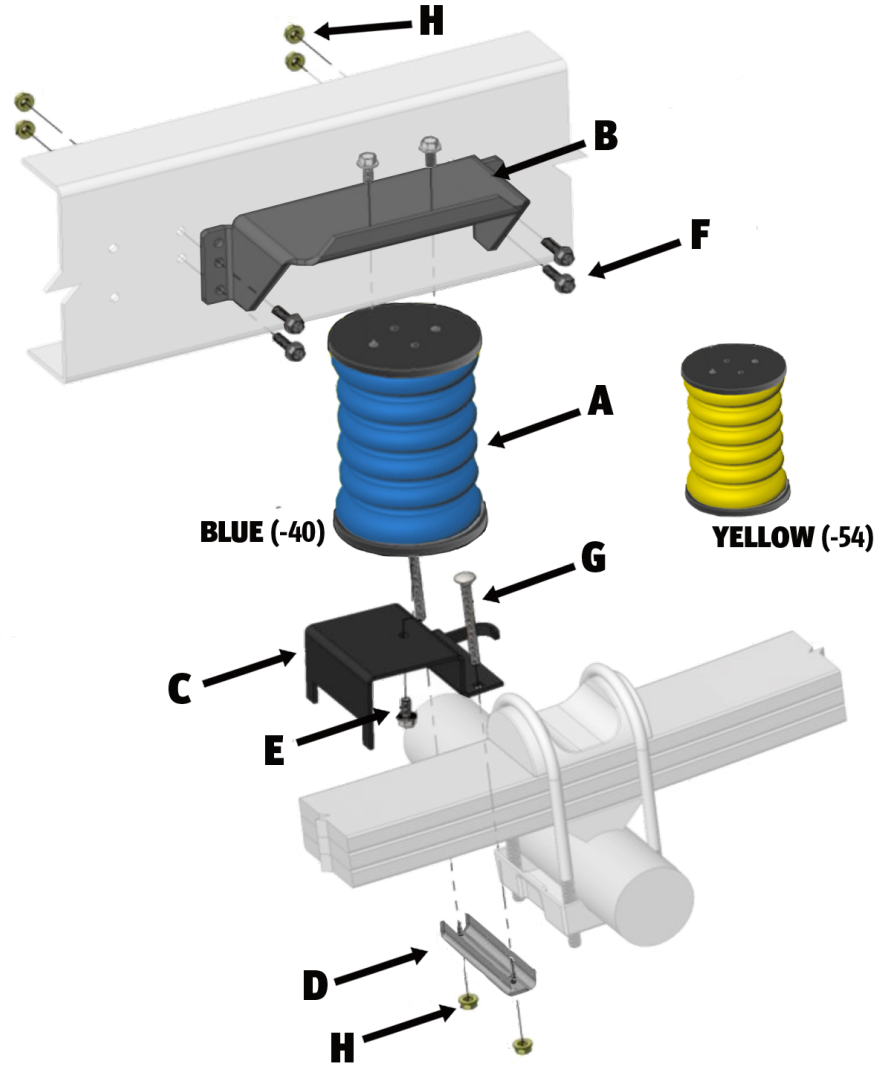

PASSENGER SIDE (DRIVER'S SIDE IDENTICAL)

Part Number: K-10-004

Product Line: SUMOSPRINGS FRONT & REAR

Page 2

SuperSprings International, Inc.

505 Maple Avenue
Carpenteria, CA 93013

Installation Support

+1 (800) 898-0705
support@supersprings.com

superspringsint.com

SAFETY NOTICE: We recommend installation be done by a professional or persons with sound mechanical knowledge.

WARNING: These instructions are a general guide for installation. SuperSprings International, Inc. assumes no liability for the actual installation process. Consumers and installers should apply common automotive safety practices when raising and working on any vehicle. **Do not put yourself in a position where, if the vehicle were to move unexpectedly, you may be injured.** SuperSprings' products are designed to improve vehicle ride quality. Do not load any vehicle beyond the manufacturer's specifications.

Never exceed the manufacturer's Gross Vehicle Rating (GVWR) located on your vehicles identification tag.

BEFORE INSTALLATION: Ensure the vehicle is on a level surface, the parking brake is ON, with the ignition OFF, and place blocks in front of and behind the front tires to prevent the vehicle from moving.

DURING AND/OR AFTER INSTALLATION: Ensure emergency brake cables are not touching the SuperSprings. Secure any cables out of the way with zip ties or by re-routing. **Ensure all A/C lines, brake cables, and frame are clear of contact or interference.**

REV. 001 | JULY 2021

PART NUMBER

K-10-004



IMPORTANT NOTICE: Your part may have been loosely preassembled to show the final product as it will be once installed on your vehicle. Please disassemble the product before proceeding to the installation.

INSTALLATION

1. Park the vehicle on a hard, level surface and engage the emergency brake. Place blocks in front and behind the wheels to prevent rolling. Observe all safety precautions and wear safety glasses.
2. Raise the front of the vehicle until the axle hangs free. Rest the frame on safety jack stands rated for the weight of the vehicle. Removal of the front wheels is optional.
3. Using a 13mm socket and 15mm wrench for the corresponding nut, remove the factory bump stop. Make sure you keep the factory hardware – you’ll need it for the installation of the upper bracket.
NOTE: On the passenger side, remove the bolt only; the nut is welded inside the frame.
4. Insert two 3/8-16” flanged hex bolts [ITEM F] into the outside holes of the upper bracket [ITEM B] and let it hang freely. Using the factory bump stop bolt and nut, attach the upper bracket [ITEM B] to the bottom of the frame in the same position as the factory bump stop was installed.
5. Bolt upper half of the SumoSpring [ITEM A] to the upper bracket [ITEM B] using the previously installed bolts and tighten securely with a wrench.
6. Attach the lower bracket [ITEM C] to the bottom half of the SumoSpring [ITEM A] in the correct orientation using a single 3/8-16 X 7/8” flat head cap screw [ITEM G]. Please note that the lower bracket must be positioned so that the center hole is offset outward toward the wheel.
IMPORTANT NOTE: Make sure you place a 5/16 washer [ITEM E] between each of the J-bracket clamps [ITEM D] and the lower bracket [ITEM C]. However, if the lower bracket is not tight to the spring plate after the bolts are tightened, you can remove them to ensure a tighter fit.
7. Using the two 3/8-16 X 1.5” flange hex bolts [ITEM H], two 5/16” washers [ITEM E] and two 3/8” flange nuts [ITEM I], attach two J-bracket clamps [ITEM D] to the lower bracket [ITEM C] making sure to hook them under the shock mount/spring plate.
8. With everything in place, ensure that the top and bottom halves of SumoSpring are visually aligned and tighten the bottom bracket bolts securely.
9. Repeat steps 3 – 8 on the other side of the vehicle.
10. Moving to the rear, Attach the upper frame bracket [ITEM B] to the top of the SumoSpring [ITEM A] using two 3/8 – 16 x 3/4” serrated flange hex bolts [ITEM E]. Attach the lower bracket [ITEM C] to the bottom of the SumoSpring using a 3/8 – 16 x 3/4” serrated flange hex bolt [ITEM E].

Part Number: K-10-004

► Product Line: SUMOSPRINGS FRONT & REAR

Page 3

SuperSprings International, Inc.

505 Maple Avenue
Carpinteria, CA 93013

Installation Support

+1 (800) 898-0705
support@supersprings.com

superspringsint.com

SAFETY NOTICE: We recommend installation be done by a professional or persons with sound mechanical knowledge.

WARNING: These instructions are a general guide for installation. SuperSprings International, Inc. assumes no liability for the actual installation process. Consumers and installers should apply common automotive safety practices when raising and working on any vehicle. **Do not put yourself in a position where, if the vehicle were to move unexpectedly, you may be injured.** SuperSprings’ products are designed to improve vehicle ride quality. Do not load any vehicle beyond the manufacturer’s specifications.

Never exceed the manufacturer’s Gross Vehicle Rating (GVWR) located on your vehicles identification tag.

BEFORE INSTALLATION: Ensure the vehicle is on a level surface, the parking brake is ON, with the ignition OFF, and place blocks in front of and behind the front tires to prevent the vehicle from moving.

DURING AND/OR AFTER INSTALLATION: Ensure emergency brake cables are not touching the SuperSprings. Secure any cables out of the way with zip ties or by re-routing. **Ensure all A/C lines, brake cables, and frame are clear of contact or interference.**

REV. 001 | JULY 2021

PART NUMBER

K-10-004



IMPORTANT NOTICE: Your part may have been loosely preassembled to show the final product as it will be once installed on your vehicle. Please disassemble the product before proceeding to the installation.

INSTALLATION

4. Insert two 3/8-16 x 4" carriage bolts [ITEM G] into the two square openings in the lower bracket [ITEM C] in such a way that they straddle the factory spring-pack. Position the lower bracket so that the curved side finger captures the factory u-bolt.

5. Using the U-bracket strap [ITEM D], the two carriage bolts [ITEM G], and two 3/8 - 16 top-lock nuts [ITEM I], fasten the lower bracket [ITEM C] to the factory spring pack.

6. Repeat steps 3-5 on the other side of the vehicle.

7. Jack up the vehicle axle until the upper frame bracket [ITEM B] is in the correct position on the frame. Position the bracket so the two lower holes are 6" down from the top of the frame. Using the bracket as a template, drill the lower mounting holes through the frame with a 3/8" drill bit.

8. Insert two 3/8-16 x 1.25" hex bolts and 3/8" top lock nuts in lower holes.

9. Using the upper bracket [ITEM B] holes as a guide, drill two upper holes using a 3/8" drill bit.

[IMPORTANT NOTE: Make sure there is clearance on all cables/service lines inside the frame prior to drilling.]

9. Repeat step 7-19 on opposite side.

11. Raise the vehicle, remove safety jack stands, and carefully lower vehicle to the hard surface. Remove the blocks in front and back of the rear wheels and release the emergency brake.

12. Register the warranty for your SuperSprings International part. A warranty card can be found in the box your part came in.

Part Number: K-10-004

► Product Line: SUMOSPRINGS FRONT & REAR

Page 4

SuperSprings International, Inc.

505 Maple Avenue
Carpinteria, CA 93013

Installation Support

+1 (800) 898-0705
support@supersprings.com

superspringsint.com

SAFETY NOTICE: We recommend installation be done by a professional or persons with sound mechanical knowledge.

WARNING: These instructions are a general guide for installation. SuperSprings International, Inc. assumes no liability for the actual installation process. Consumers and installers should apply common automotive safety practices when raising and working on any vehicle. **Do not put yourself in a position where, if the vehicle were to move unexpectedly, you may be injured.** SuperSprings' products are designed to improve vehicle ride quality. Do not load any vehicle beyond the manufacturer's specifications.

Never exceed the manufacturer's Gross Vehicle Rating (GVWR) located on your vehicles identification tag.

BEFORE INSTALLATION: Ensure the vehicle is on a level surface, the parking brake is ON, with the ignition OFF, and place blocks in front of and behind the front tires to prevent the vehicle from moving.

DURING AND/OR AFTER INSTALLATION: Ensure emergency brake cables are not touching the SuperSprings. Secure any cables out of the way with zip ties or by re-routing. **Ensure all A/C lines, brake cables, and frame are clear of contact or interference.**

REV. 001 | JULY 2021