

Installation Instructions BR10 Universal Light Plate Accesory # 241731T

Do not attempt to install this product on any other vehicle that the one listed avobe!

Part list

Item	Qty.	Part #	Description
1	2	241731T5AB	Light Pod Complement

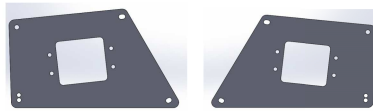

NOTE: This plate are used to install Rigid Industries D - Series flush mount lights (Sold separately)



1-. Remove (4) 1/4 x 1/2" bottom head bolts and discard the Light Plate.

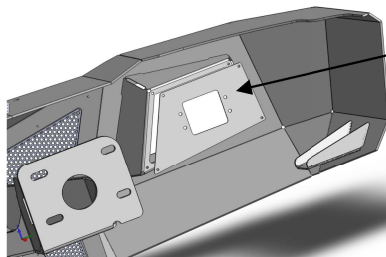

2-. Install the Light Plate using the bolts that were removed.



Light Pod Complement installed

Tool required:

11mm, 7/16" Socket
11mm, 7/16" Wrench
5/32" Allen
Ratchet

Approximate installation time: 10 min.

Read the assembly and installation instructions completely and verify that all of parts listed are accounted for. If you have defective, missing or damaged parts or need assistance, please contact *Go Rhino Products* for fast, friendly customer service at: 1-888-427-4466 or email:

warranty@gorhino.com