

Installation Instructions BR10 Light Pod Cover Plate Dually Accessory Part # 241732T

Part list

Item	Qty.	Part #	Description
1	2	241732T6AA	Light Pod Complement

*For use with Rigid 3 1/4" X 3 1/4" D-Series flush mount LED Lights (not included)

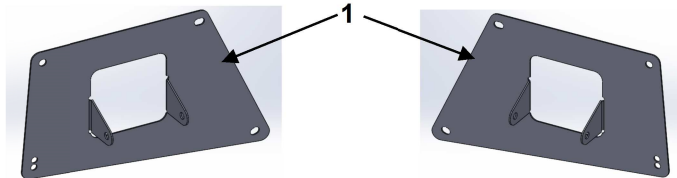

Tool required:

7/16" Socket
7/16" Wrench
Ratchet
5/32" Hex Key

Approximate installation time: 15 min.

Read the assembly and installation instructions completely and verify that all of parts listed are accounted for. If you have defective, missing or damaged parts or need assistance, please contact Go Rhino Products for fast, friendly customer service at: [1-888-427-4466](tel:1-888-427-4466) or email: warranty@gorhino.com

1-. If Installed, remove the nuts and bolts, and the blank light pod plates from the bumper shell.

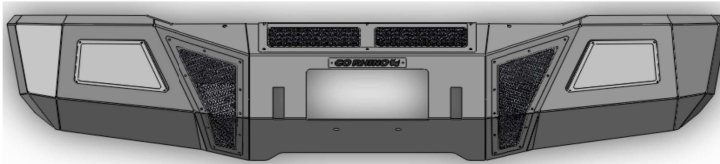

2-. Attach and secure each Light Mount Plate to the Bumper Shell using (4) 1/4" x 1/2" button head bolts and (4) nylon lock nuts supplied with the Bumper shell.

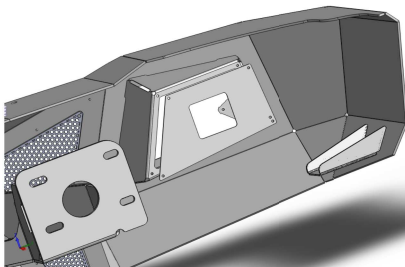

2-. Install the Rigid 3 1/4" x 3 1/4" D-Series flush mount LED (not included) to the Light Mount Plates using the nuts and bolts supplied with the lights.