

INSTALLATION INSTRUCTIONS

RB10/RB20
RUNNING BOARDS

TOYOTA TUNDRA CREW MAX

63441687

69441687

Parts list				
Item	QTY	Códe	Description	Max Torque
1	1 set	630087/690087	Running Boards	
2	1 set	6344154AA	Front Bracket	
3	2 sets	6344154BA	Rear and rear center bracket	
4	1 set	6344154CA	Front center bracket	
5	8 piece	6300874AA/4BA	U-bracket	
6	32 piece		M8 x 30mm SEMS Bolts	18 Lb. Ft.

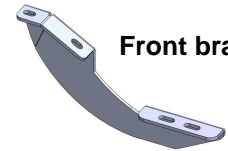

Front bracket

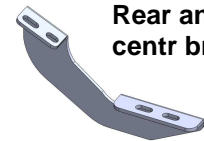

**Rear and rear
centr bracket**

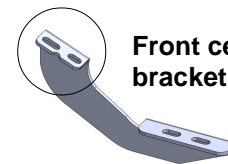

**Front center
bracket**

Required Tools (Not included)

- A. Ratchet w/ extension
- B. 12 mm socket
- C. 13 mm socket
- D. 15 mm socket

1.- Before beginning the installation, please read all directions carefully and verify that all necessary hardware is accounted for. If any parts are missing, stop the installation and contact your distributor immediately.

2.- To maintain and care this product keep it clean and do not use abrasive cleaners or polish waxes. We recommend to use only non-abrasive automotive wax such as pure carnauba to avoid scratches and rust.

3.- The approximate installation time is 45 min.

3. To install **middle and rear brackets** use two M8 x 30mm SEMS bolts for each bracket. See **Picture 4** and repeat it in the opposite side. Leave loose.

1. See pictures **1, 2 Y 3** and locate the holes where the brackets are going to be installed.

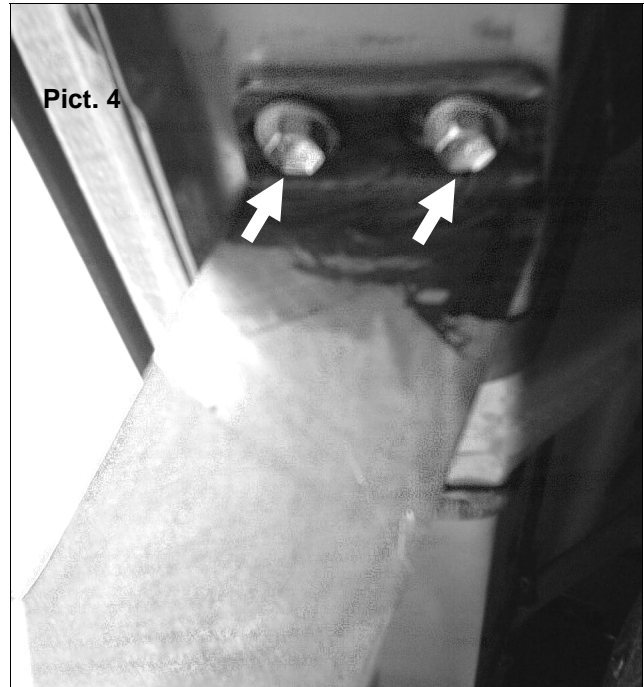
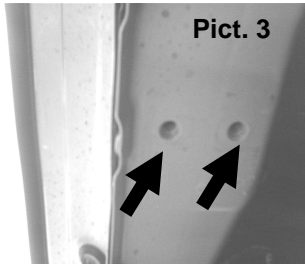
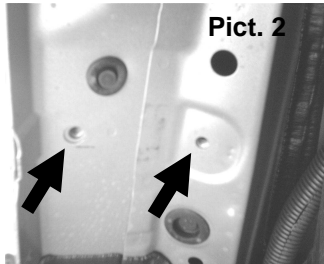
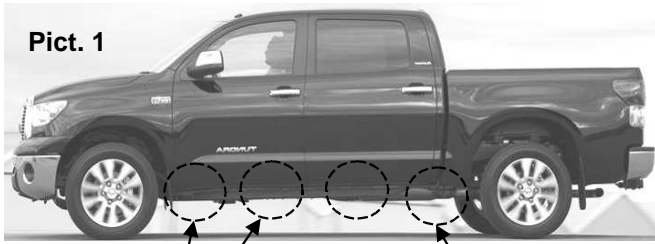

2. For the **Front bracket** install two M8 x 30mm SEMS bolts. See **Picture 5** and repeat it in the opposite side of the vehicle. Leave loose.

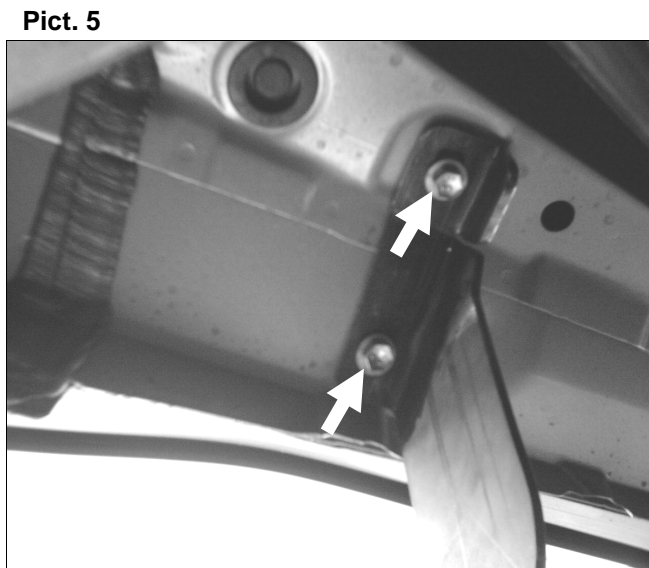

4. Place the running board on top of the mounting brackets. Position the (4) U-brackets inside the running board body, and align the U-brackets with the mounting brackets. Attach the running board and U-brackets to each mounting brackets using (2) M8 x 30mm SEMS bolts. ILLUSTRATION 1.

ILLUSTRATION 1

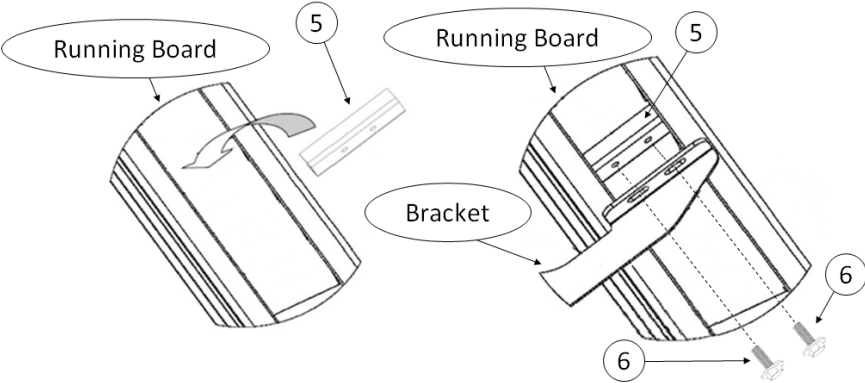

Pict. 6

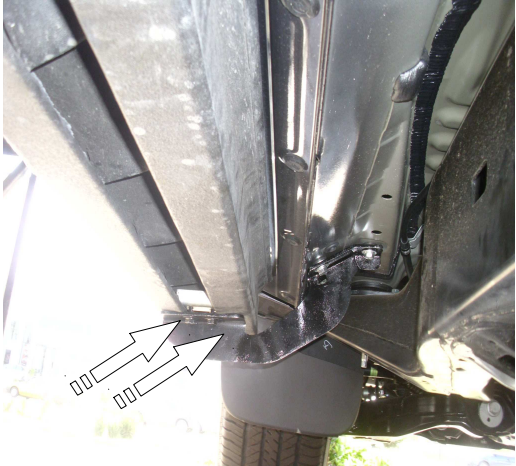

- 5. Align the running board and then tighten all bolts.
- 6. Periodically check your product because it may need a re-tighten of bolts.
- 7. Fill the warranty card and place it inside your vehicle's glove box.

